



固體電子有限公司

Solitronics Engineering Ltd.

Tel : (852) 2730-8145

Fax : (852) 2730-3245

D-Fax : (852) 3003-3056

2202, Perfect Ind. Bldg., 31 Tai Yau St., Kowloon, Hong Kong S.A.R., China E-mail : info@solitronics.com

IEC AC Mains Connectors & Receptacles

Brand mark: JEC

Specifications:

1. Rating: 10A 250VAC

2. Insulation Resistance: DC 500V 100M Ω (min)

3. Dielectric Strength: 2000VAC/1 Minute

4. Housing Material: P.B.T. Or Nylon #66

5. Safety Approval:

6. (.) Panel Thickness: (08)0.8m/m, (10)1.0m/m, (15)1.5m/m, (20)2.0m/m, (30)3.0m/m

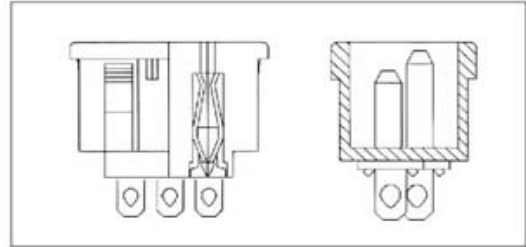

JR-101



N.W.:10g

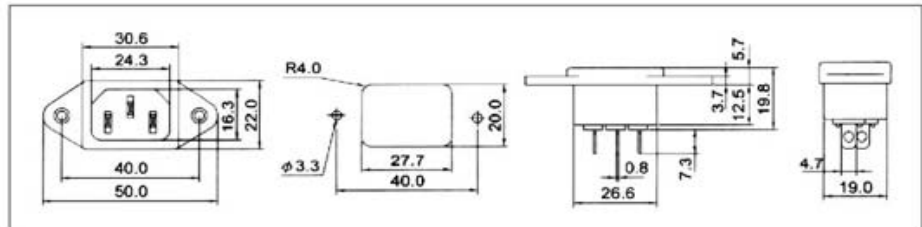

JR-101(PCB)



N.W.:12g

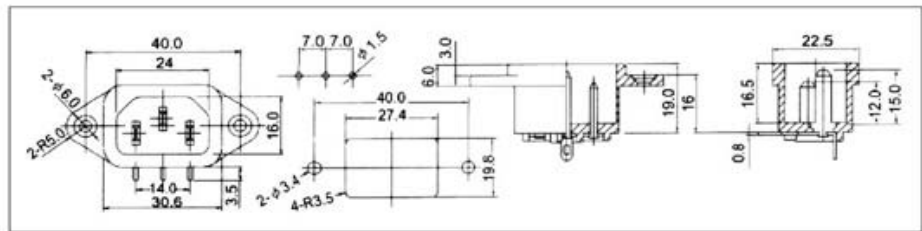

JR-101S-(1.0)



N.W.:8g

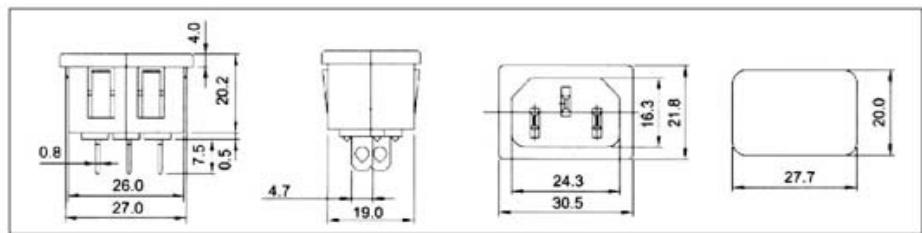

JR-101S-(1.5)



N.W.:8g

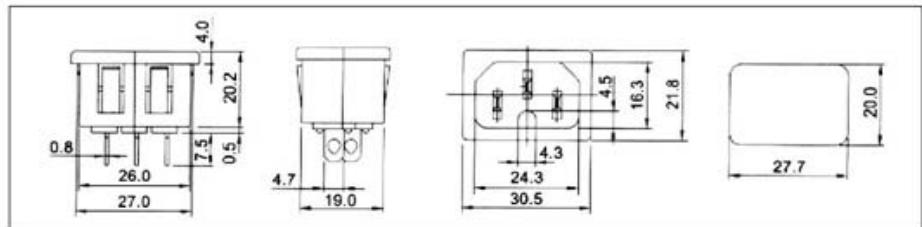

JR-101S-G



N.W.:8g

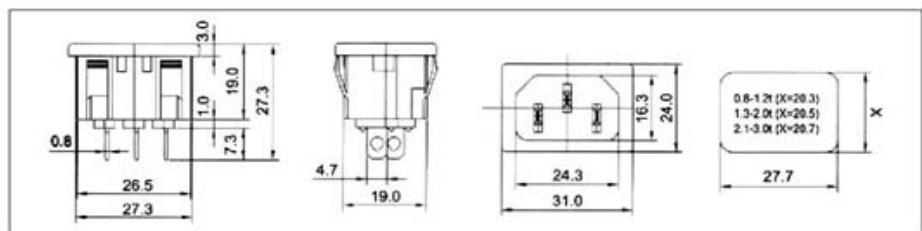



固體電子有限公司

Solitronics Engineering Ltd.

2202, Perfect Ind. Bldg., 31 Tai Yau St., Kowloon, Hong Kong S.A.R., China

Tel : (852) 2730-8145

Fax : (852) 2730-3245

D-Fax : (852) 3003-3056

E-mail : info@solitronics.com

IEC AC Mains Connectors & Receptacles

INLET JR - 101S PC TYPE SERIES

JR - 101S PC - [] - []

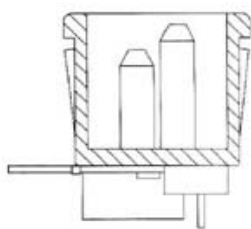

Lead Length(L)	
A	3.2mm
B	3.6mm
C	5.5mm
D	6.8mm
E	10.8mm

Panel Thickness(T)	
1.0	1.0m/m
1.5	1.5m/m
2.0	2.0m/m
3.0	3.0m/m

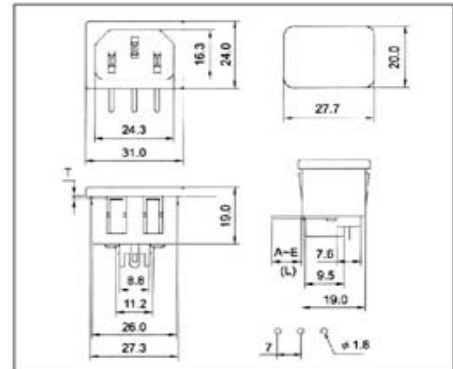

JR-101S-PCA(1.5)



JR-101S-PCB(1.0)



INLET JR - 101S-G PC TYPE SERIES

JR - 101S - G - PC - []

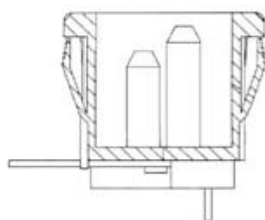

Lead Length(L)	
A	3.0mm
B	3.6mm
C	5.3mm
D	6.4mm
E	10mm

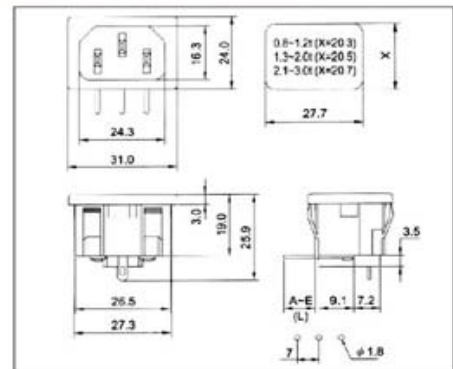

JR-101S-G-PCA



JR-101S-G-PCB





固體電子有限公司

Solitronics Engineering Ltd.

2202, Perfect Ind. Bldg., 31 Tai Yau St., Kowloon, Hong Kong S.A.R., China

Tel : (852) 2730-8145

Fax : (852) 2730-3245

D-Fax : (852) 3003-3056

E-mail : info@solitronics.com

JR-201 Mains-Inlet

Brand mark: JEC

Specifications:

1. Rating: 2.5A 250VAC
2. Insulation Resistance: DC 500V 100M Ω (min)
3. Dielectric Strength: 2000VAC/1 Minute
4. Housing Material: Nylon #66 UL 94V-2 or 94V-0 (Snap Type)
5. Safety Approval:

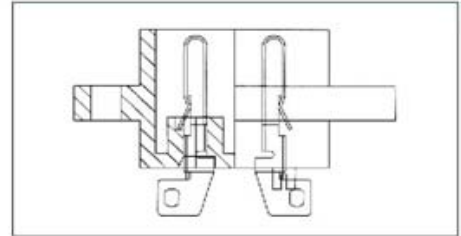

JR-201S-(1.5)



N.W.:4g

Panel Thickness(T)	
1.5	1.5m/m
2.0	2.0m/m

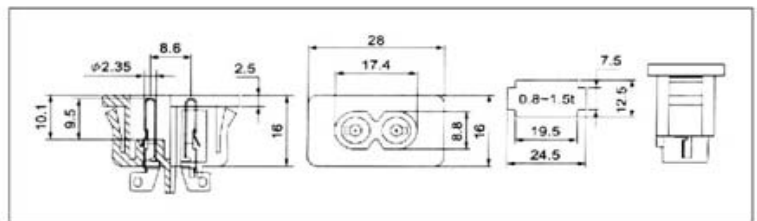

JR-201SD8-(1.5)



N.W.:4g

Panel Thickness(T)	
1.5	1.5m/m
2.0	2.0m/m

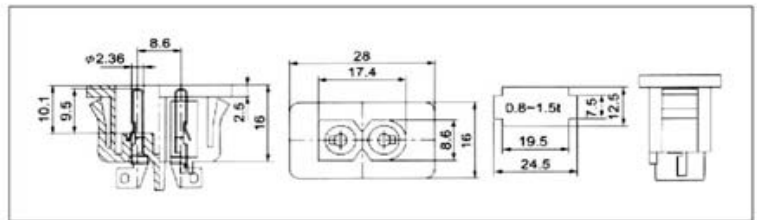

JR-201S-01-(1.5)

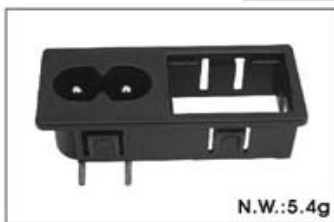

N.W.:5.4g

Panel Thickness(T)	
1.5	1.5m/m
2.0	2.0m/m

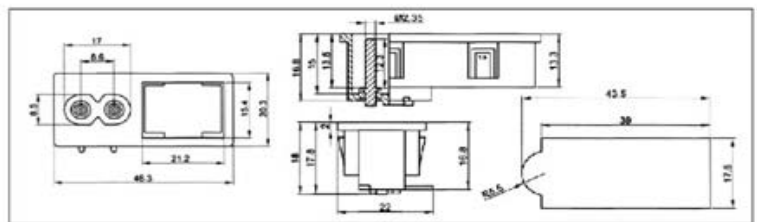

JR-201SD8-01-(1.5)

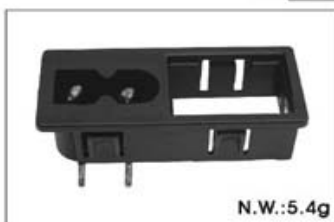

N.W.:5.4g

Panel Thickness(T)	
1.5	1.5m/m
2.0	2.0m/m

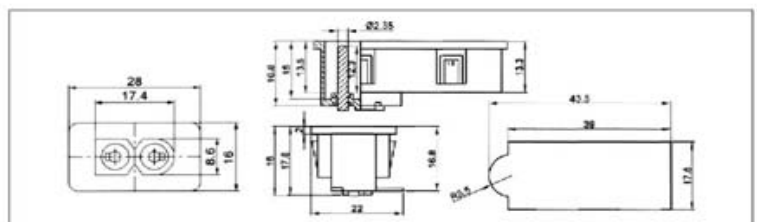



固 體 電 子 有 限 公 司

Solitronics Engineering Ltd.

2202, Perfect Ind. Bldg., 31 Tai Yau St., Kowloon, Hong Kong S.A.R., China

Tel : (852) 2730-8145

Fax : (852) 2730-3245

D-Fax : (852) 3003-3056

E-mail : info@solitronics.com

JR-307 Mains Inlet

Brand mark: JEC

Specifications:

- 1. Rating: 2.5A 250VAC
- 2. Insulation Resistance: DC 500V 100M Ω (min)
- 3. Dielectric Strength: 2000VAC/1 Minute
- 4. Safety Approval:

JR-307(Screw Type)

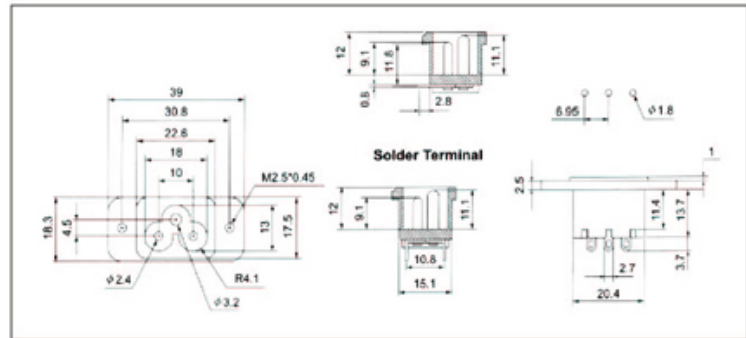

JR-307(E Type)

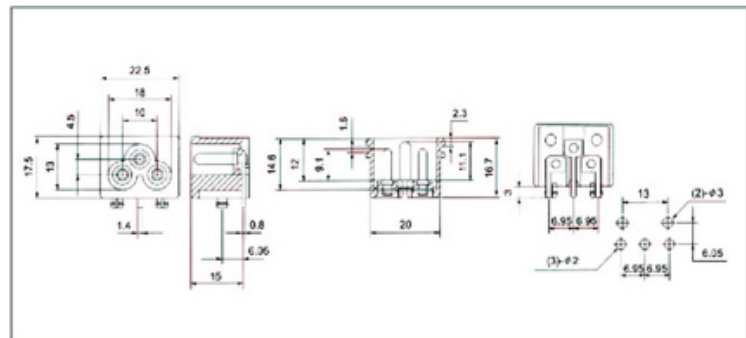



固 體 電 子 有 限 公 司

Solitronics Engineering Ltd.

2202, Perfect Ind. Bldg., 31 Tai Yau St., Kowloon, Hong Kong S.A.R., China

Tel : (852) 2730-8145

Fax : (852) 2730-3245

D-Fax : (852) 3003-3056

E-mail : info@solitronics.com

IEC Mains AC Cord Plug

Specifications:

1. Rating: 10A 250VAC
2. Insulation Resistance: DC 500V 100M Ω (min)
3. Dielectric Strength: 2000VAC/1 Minute
4. Housing Material: Nylon#66 UL 94-2 or 94V-0
5. Safety Approval:



RL-2231

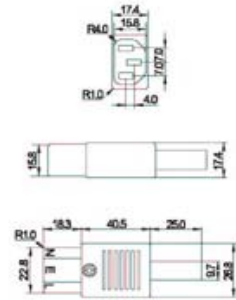

RL-2231-A

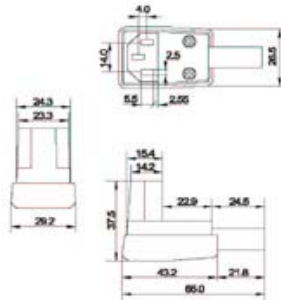

RL-2231-2

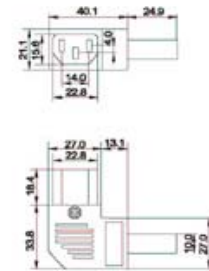

RL-2231-H

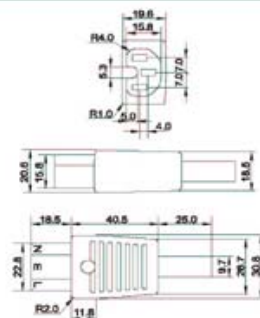

RL-2233

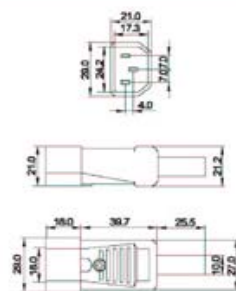

RL-2233-A

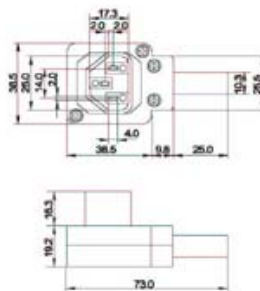

RL-2233-2

